

# FOR SALE

## RESIDENTIAL - CONDOMINIUM 4,176SQFT (388SQM) / CALL FOR PRICE!

+65 9679 6417



Penthouse

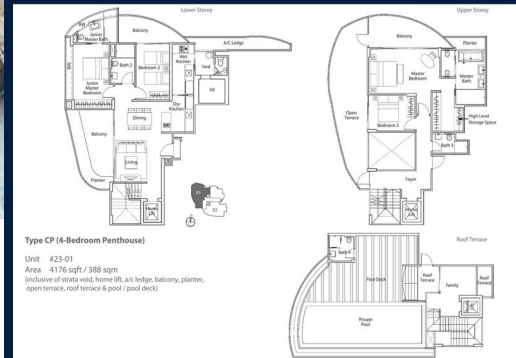

Type CP (4-Bedroom Penthouse)

Unit #23-01  
Area 4176 sqft / 388 sqm  
(inclusive of strata void, home lift, air ledges, balcony, planter, open terrace, roof terrace & pool / pool deck)

**BONTEMPI**  
CUCINE

### RESIDENTIAL - CONDOMINIUM

**LUCIDA, 2, SUFFOLK ROAD, NEWTON, NOVENA, SINGAPORE 307780**

- LISTING ID: SGLD73289865
- TENURE: FREEHOLD
- TITLE: N/A
- SIZE BUILT-UP: 4,176SQFT (388SQM)
- SIZE LAND: 20,383SQFT (1,894SQM)
- NO. OF FLOORS: 29
- FLOOR/LEVEL: N/A - PENTHOUSE
- BED ROOMS: 4
- BATH ROOMS: 4
- MAIDS ROOMS: N/A
- PARKING SPACES: N/A
- LAYOUT TYPE: REGULAR
- FACING: N/A
- VIEWING: OTHER
- SELLING PRICE: **CALL FOR PRICE!**
- COMPLETION YEAR: 2012
- CONDITION: ORIGINAL CONDITION
- FURNISHING: PARTIALLY FURNISHED
- LISTING DATE: JUL 24, 2019

### LUCIDA

Spacious 4,176sqft (388sqm), partially furnished, 4 bedroom, 4 bathroom Condominium for Sale. Completed in 2012, this penthouse unit is in original condition. Others: Freehold This property is currently vacant and ready to move in. Located in Singapore's district D11 near Newton, Novena in the area Newton (Central region).

#### INTERIOR FACILITIES

- Air-Conditioning
- Balcony

#### OTHER INTERIOR FEATURES

- Cooker Hob/Hood
- Dishwasher
- Fridge
- Intercom

#### EXTERIOR FACILITIES

- 24 Hours Security
- Covered Car Park
- Jacuzzi
- Landscaped Garden

VISIT THIS PROPERTY AT: <https://www.cityproperty.info/property/SGLD73289865>

### JOANNE LI - HUTTONS ASIA PTE LTD

3 Bishan Place #05-01 CPF Bishan Building  
D20, 579838, Singapore

+65 9679 6417  
WhatsApp Me

li.joanne.joanne@gmail.com

<https://www.cityproperty.info>



Scan QR Code

**Huttons** Call for Viewing  
The Agency of Choice +65 9679 6417